

## VISTA ESTATE STAGE 2

Sea Vista Developments has created an affordable brand new 3 bedroom townhouses.

Location: 14-18 Bade Street, Nambour, Queensland

Exciting opportunity to own a quality three bedroom townhouse in the heart of Nambour, competitively price from low \$300,000

This modern townhouses are fabulously located for, schools, Hospital, shops, transport and are uniquely located with a running stream though the middle of the complex , which is complimented by large walkways stretching from one side of the complex to the other . Each townhouse has three large bedrooms and ensuite, separate dining and lounge areas, large laundry, remote control double lock up garage, alarm system, functional kitchen, extremely large deck off the master bedroom and a deck leading out to a private courtyard,. The townhouses provide an excellent low maintenance alternative to large houses in very central location with walking distance to shopping centre

**A must to inspect.** For further details contact:

Alf Sorbello

Office : 12/24 Hooper Road,  
Kundapark, Queensland , 4556  
Ph: 07 5445 8222  
Fx: 07 5445 6322  
Mb: 0418 242 446

Email: [seavista@ozemail.com.au](mailto:seavista@ozemail.com.au)



<http://www.seavista.net.au>

# FLOOR PLANS

(Floor Plan One)

## Ground Floor Plan



## First Floor Plan



(Floor Plan Two)

**Ground Floor Plan**



**First Floor Plan**



# SITE PLAN

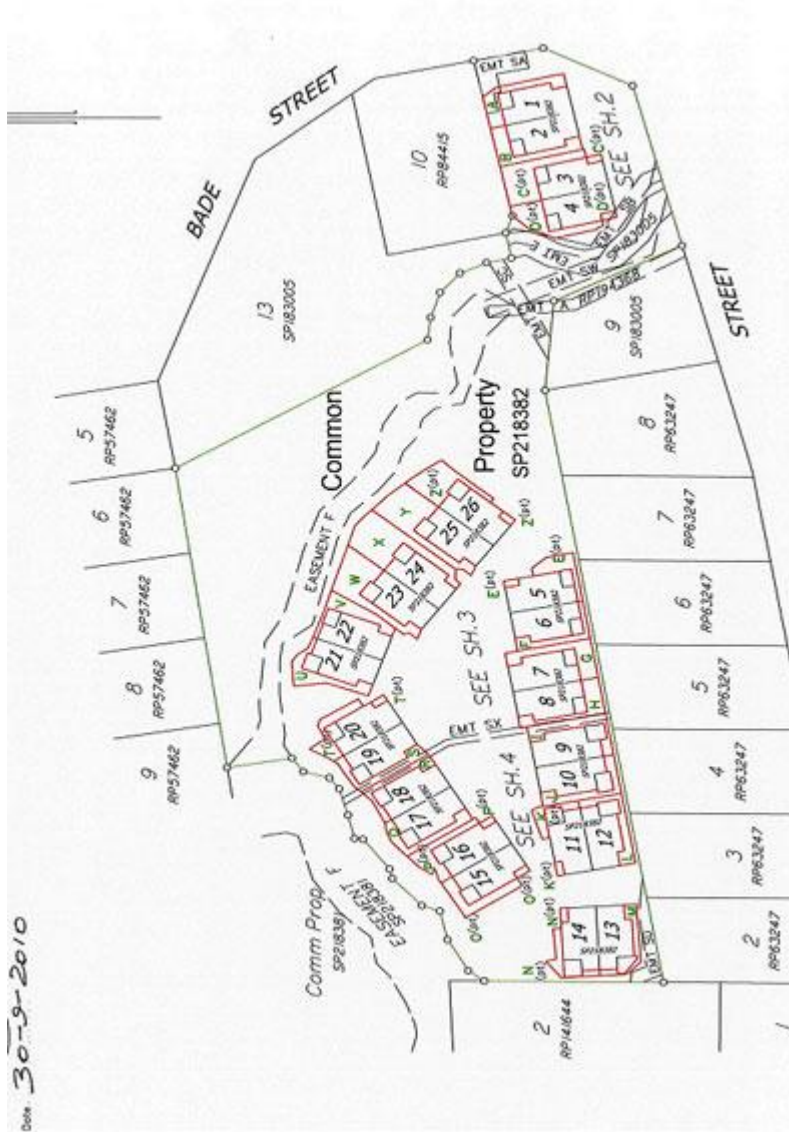

# INCLUSION LIST

## 3 Bedrooms + Double Garage

### Specifications

#### **EXTERNAL**

- \* Lockup Garage
- \* Private Courtyard & Balcony
- \* Clothes Line-Para Line
- \* Turf & Landscaping (as per plan)
- \* Cement render & Brickwork (where indicated on plan)
- \* Color bond fascia & guttering
- \* Fly screens to all windows (excluding Garage)
- \* Letter Box
- \* TV Antenna

#### **PAINT**

- \* Wall- Two coats of washable low sheen
- \* Ceiling – Two coats of washable sheen

#### **KITCHEN**

- \* Laminated kitchen cupboards with Laminated rolled bench top
- \* Builder selected stainless steel under Bench oven and cook top
- \* Builder selected ceramic tiles
- \* 1 ½ bowl stainless steel sink and Flick mixer tap

#### **BEDROOMS**

- \* Carpet
- \* Built in Wardrobes

#### **BATHROOM**

- \* Builder selected ceramic tiles
- \* Towel rail and toilet roll holder
- \* Clear glass shower screen
- \* Dual flush toilet suite
- \* White bath
- \* Builder selected polyurethane vanity
- \* Wall Mirror
- \* Stainless steel single bowl laundry tub

#### **INTERNAL**

- \* Builder selected carpet to non-wet arrears (refer to plan)
- \* Builder selected light fitting (excluding garage)
- \* Builder selected vertical drapes to sliding door
- \* Builder selected vertical drapes to windows (excluding garage)
- \* Sliding door to robes (where shown)
- \* Hot water system
- \* Phone Point
- \* Insulation as per plan
- \* Termite resistant timber frames
- \* Kordon termite protection
- \* Alarm
- \* Garage Remote